

# Figure 640 06 KHS Surface Mounted Venturi Flow Distributor Group, Flow and return with FT, returns DN 15 /15



Technical properties	
Fluid-contacting parts made completely of gunmetal	
For induced flows and continuous water exchange in the sanitary block area	
With venturi nozzle	
Minimum pressure loss	
Maximum flow isolating ball valve DIN-/DVGW approved according to DIN EN 13828, W 570	
Maximum flow isolating ball valve with removable 'Top Entry' inner head part	
Soundproofing tested in accordance with DIN EN ISO 3822	
Pressure stage PN 16	
Stagnant-zone-free	
Insulating shell building material class B1 compliant with DIN 4102	



640 06 KHS-Venturi Distributor Group for surface mounting with female thread

Product description / Tender text	
<b>KEMPER KHS-Venturi Distributor Unit Group</b> , for surface mounting, for induced flow in sanitary blocks in the supply ring for sanitary installation for cold-water tapping valves and furnishings, especially suitable for the KEMPER KHS Hygiene System comprising:	
<b>Flow distributor</b> based on the Venturi principle, with sanitary block feed line and sanitary block return line with union nut for direct connection to the maximum flow isolating ball, made entirely out of gunmetal, resistant against aggressive water, with soundproofing certificate,	
<b>Maximum flow isolating ball valves</b> , zero loss version, compliant with DIN EN 13828 corresponds to the drinking water hygiene requirements according to DVGW W 570, made entirely from gunmetal, resistant against aggressive water, brass-free in areas that touch fluids, with maintenance-free spindle sealing, 'Top Entry' inner head part can be removed from above, made with EPDM gasket body with rotating-supported gunmetal closing body, stagnant-zone-free, with ergonomically designed 90° rotating handle, with DIN/DVGW and soundproofing certificate, rated pressure PN 16 and	
<b>Insulating shells</b> for maximum flow isolating ball valve and flow distributor, made of closed cell foamed polyethylene with additional, permanent outer shell, building material class B1 compliant with DIN 4102, thermal conductivity according to ISO 2581 0.035 W/mK, incl. stopper clips, can be sealed diffusion-resistant with commercially available glues,	
<b>Flow distributor inlet and outlet side</b> with female thread from DN 15 (1/2") to DN 32 (1 1/4"),	
<b>Sanitary block feed line and return line</b> with female thread DN 15 (1/2"),	
<b>Surface mounted maximum flow isolating ball-maximum flow isolating ball valve</b> with female thread DN 15 (1/2")	

Dimensions					
Nominal width	DN	15	20	25	32
Overall height (H 1)	mm	48,5	58,5	68,5	73,5
Length (L1)	mm	185	185	185	195
Length (L2)	mm	100	100	100	100
Length (L3)	mm	84	84	84	84
Length (L4)	mm	84	84	84	84
Connection dimension (A1)		Rp 1/2	Rp 3/4	Rp 1	Rp 1 1/4
Connection dimension (A2)		Rp 1/2	Rp 1/2	Rp 1/2	Rp 1/2
Connection dimension (A3)		Rp 1/2	Rp 1/2	Rp 1/2	Rp 1/2

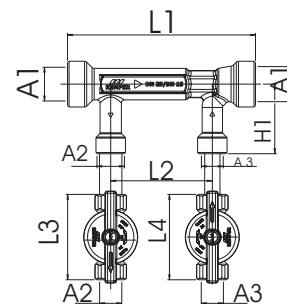

Materials	
Flow distributor	Gunmetal
Housing, inner head part	Gunmetal
Seal element	EPDM
Handle	Plastic
Insulating shells	Polyethylene

**Figure 640 06 KHS Surface Mounted Venturi Flow Distributor Group, Flow and returns with FT, returns DN 15 /15**

Technical information
<p><b>Scope of application</b></p> <ul style="list-style-type: none"> <li>- The KHS Venturi Distributor Unit provides a facility for controlled forced flow in cold drinking water systems by using tailor-made and innovative pipeline network structuring.</li> <li>- Together with the automatic KHS flushing equipment, a continuous drinking water exchange is produced to implement drinking water system operation in accordance with the requirements.</li> <li>- Every time water is withdrawn, which takes place in the flow path behind the KHS Venturi Distributor Unit, the water is also moved in the upstream ring lines, producing a continuous exchange.</li> <li>- That means permanent stagnation prevention.</li> <li>- Make sure the CDW line is laid out as a ring line and that all CDW consumers are looped (avoid T-installations).</li> <li>- It is recommended to calculate the hydraulic conditions in the DW system, e.g. with the Dendrit software.</li> <li>- Install the KHS Venturi Distributor Unit only together with KHS-VAV as reliable operation in bypass can only be guaranteed with these valves (0 pressure-loss).</li> </ul>

Figure	Flow distributor unit	Surface mounted-VAV	
	Throughpass	Feed line	Return line
640 06 015	FT Rp 1/2"	FT Rp 1/2 "	FT Rp 1/2"
640 06 020	FT Rp 3/4"	FT Rp 1/2 "	FT Rp 1/2"
640 06 025	FT Rp 1"	FT Rp 1/2 "	FT Rp 1/2"
640 06 032	FT Rp 1 1/4"	FT Rp 1/2 "	FT Rp 1/2"